

Scan for updates



Scan for Datasheet



solar**edge**

Quick Installation Guide

SolarEdge Fast Mount 36 (SFM36)

for Australia

Support Contact Information

In case of any technical issues with SolarEdge products, please contact us at:
<https://www.solaredge.com/service/support>

© SolarEdge Technologies, Ltd.
All rights reserved.
Version: 1.0 December 2024: Initial
Version
Subject to change without notice.

What's in the Package

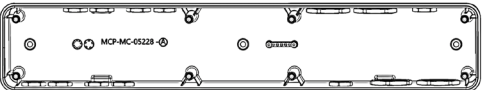

SolarEdge Fast Mount 36



SolarEdge Fast Mount 36 Cover



Cable Nipples

Spacers 3x

Screw gaskets 3x

Vent

Required Tools



Drill with 32mm
hole saw



Phillips
screwdriver



Pencil



Flat
screwdriver



X 3
Mounting
screws and
wall plugs



Level

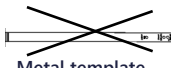

Metal template -
do not use!

Available Configurations

Configuration 1

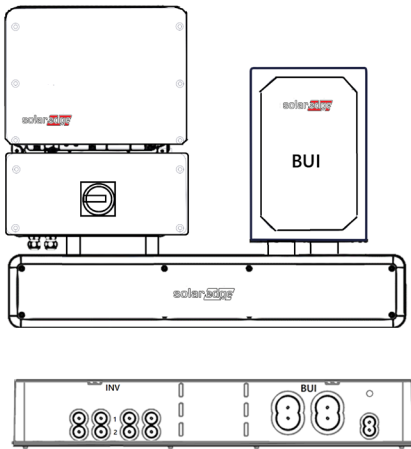

Configuration 2

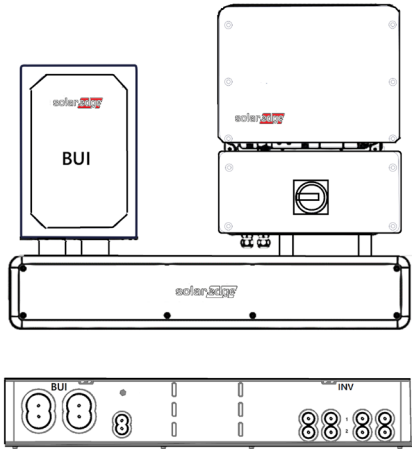

Note: Installation procedure is identical for configurations 1 and 2, illustrations use configuration 1 as an example.

Safety and Handling Instructions

- Read this entire document before installing the SolarEdge Connection Unit. Failure to do so or to follow any of the instructions in this document can result in electrical shock, serious injury, or death, or may damage the SFM36 and other property, it can also lead to warranty void.
- Do not discard this document! After installation, keep it adjacent to the SFM36 for future reference!
- Opening the SFM36 under power must be performed only by qualified service personnel familiar with the SFM36.

Drilling Knockouts and Mounting the SFM36

1

SolarEdge Fast Mount (SFM36) aims to facilitate outdoor cabling of SolarEdge systems.
For configuration 1 BUI on the right, use upper-side knockouts.
For configuration 2 with BUI on the left, turn the SFM36 upside down and use lower-side knockouts.

- Measure the clearance for the inverter and the BUI.
- Drill the knockouts for the Inverter and BUI nipples.
- Level the SFM36.
- Mount the SFM36 to the wall using the three screws.

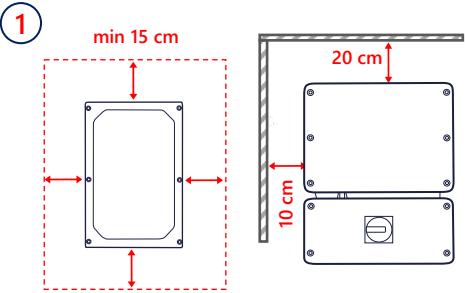

2



SFM drills for
BUI model
BI-NAUGN-01



SFM drills for inverter models:
• SE3000H
• SE5000H
• SE6000H

SFM drills for inverter models:
• SE8250H
• SE10000H

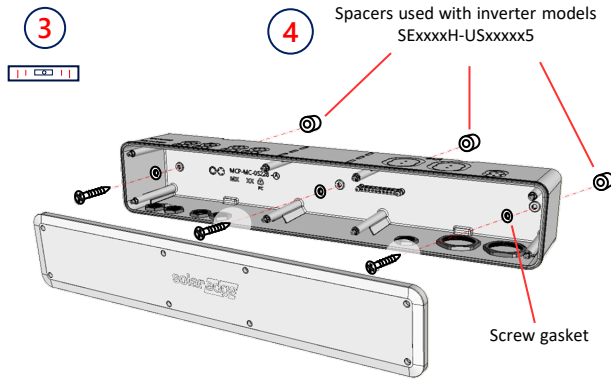

Mounting the Inverter, BUI, Battery and Connecting the Nipples

2

1

Wall drills for BUI
model
BI-NAUGN-01



Inverter models that attach to
the **top** bracket:
• SE8250H
• SE10000H

Inverter models that attach to the
bottom bracket:
• SE3000H
• SE5000H
• SE6000H

Wall drill hole that attaches to all
inverter models

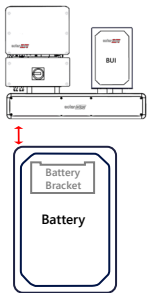

Note: Keep a
clearance of 20cm
between the battery
and the fast mount.

3

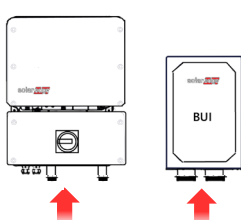

2

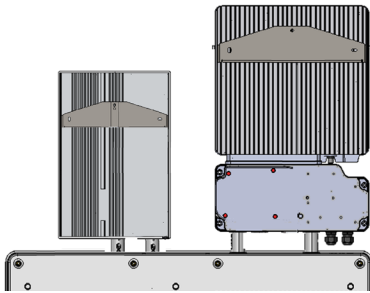
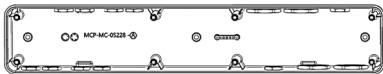

- Use the supplied template for mounting the inverter, BUI, and battery for both configurations.
- Drill the mounting holes for the inverter's and BUI's mounting brackets. Mount the template and the mounting brackets to the wall with supplied screws (two screws at least for each bracket).
- Connect the nipples to the BUI and the inverter. Close the nipple nuts.
- Hang the inverter and the BUI onto the brackets. The nipples will go through the knockouts you made.

Note: We recommend connecting nipples loosely on both sides and once inserted, tighten them firmly for a secure connection.

Connecting the Vent and Cables

3

1. Remove the plug from the vent hole, insert the vent, and tighten the nut.

2. Connect and tighten the nuts of the conduit nipples inside the SFM36. Drill and connect the conduits to the SFM36.

3. Use the Grounding bar if needed. Tighten the screws of the Grounding bar to 3 lb*ft (4 Nm).

4. Drill and connect the conduits to the BUI. Make sure that each hole is identical to the one on the SFM36 side.
IMPORTANT: Make sure to align the comm1 hole of the SFM36 with the COM1 hole of the BUI.

5. Connect all the necessary cables threading them through the nipples (refer to the Inverter and BUI installation guides for details) and close the covers.

IMPORTANT: Make sure to properly seal every drilled hole.

Closing the SFM36

4

1. Close the SFM36 cover.

2. Tighten the SFM36 cover with eight supplied screws. Tighten the screws to 2.6 lb*ft (3.5 Nm).

3. Close the covers of the Inverter and the BUI.