

# Corrosion Protected Mounting Bracket Replacement Kit for Single Phase Inverters

This document lists the content of kits prepared for replacing the mounting brackets:

- in use with an already installed and working inverter.
- packaged with a new inverter.

## Kit Contents

Brackets included in these kits are designed for use with Single Phase Inverters.

- Single Phase Inverters with HD-Wave Technology and a Product Number pattern matching **SExxxxH**.
- Single Phase Inverters with Compact Technology and a Product Number pattern matching **SExxxxM**.
- Single Phase Inverters (non HD-Wave) and a Product Number pattern matching **SExxxxA**.

Where a replacement kit contains more than one bracket that could be used, you should use the bracket that physically matches the bracket that you are replacing.

## Bracket Replacement Kit for Single Phase Inverters with HD-Wave Technology

### New Inverter Replacement Kit

- Corrosion protected New Flat bracket x 1 piece  
MCM-BR-00429

### Installed Inverter Replacement Kit

- Corrosion protected New Flat bracket x 1 piece  
MCM-BR-00429
- Corrosion protected Top Holder-side1 bracket x 2 pieces  
MCM-BR-00427
- Corrosion protected Top Holder-side2 bracket x 2 pieces  
MCM-BR-00432

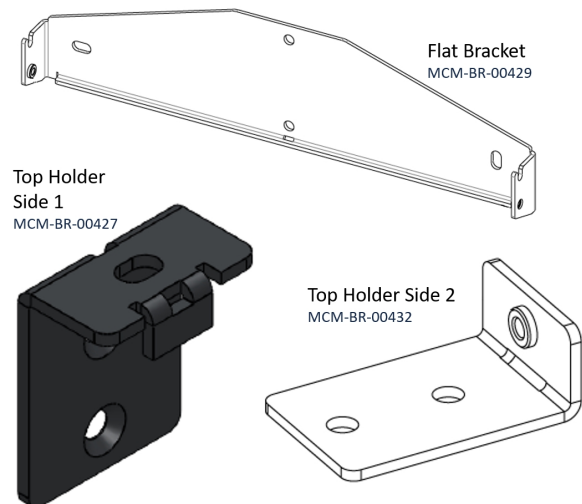

## Bracket Replacement Kit for Single Phase Inverters with Compact Technology

### New Inverter Replacement Kit

- Corrosion protected New Flat bracket x 1 piece  
MCM-BR-00428

### Installed Inverter Replacement Kit

- Corrosion protected New Flat bracket x 1 piece  
MCM-BR-00428
- Corrosion protected Top Holder-side1 bracket x 2 pieces  
MCM-BR-00427
- Corrosion protected Top Holder-side2 bracket x 2 pieces  
MCM-BR-00432

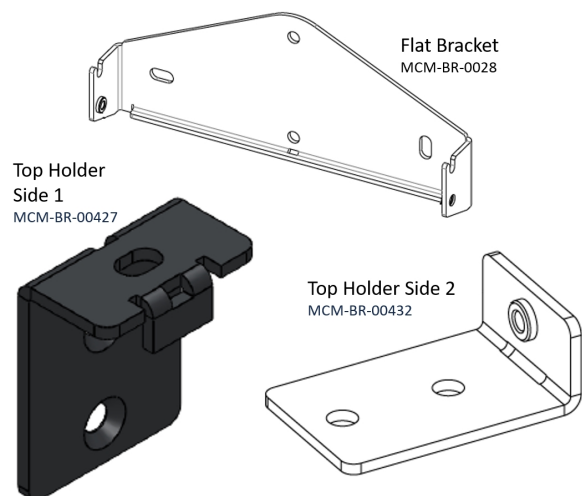

## Bracket Replacement Kit for Single Phase Inverters (non HD-Wave)

### Installed Inverter Replacement Kit

- Corrosion protected Flat bracket x 1 piece  
MCM-BR-00431
- Corrosion protected U-bracket x 1 piece  
MCM-BR-00426

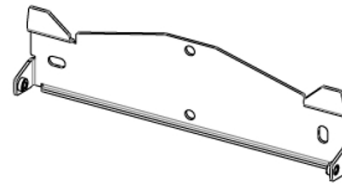

Flat Bracket  
MCM-BR-00431

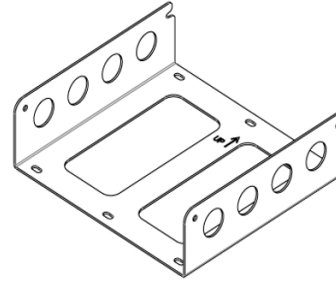

U-Bracket  
MCM-BR-00426

## Required Tools

- 4mm hex key
- Phillips screwdriver
- 3mm (small) Flat screwdriver

## Installing a New Inverter

- If you are installing a new inverter then use the **Corrosion Protected New Flat mounting bracket** that you received in the replacement kit instead of the bracket packaged with the inverter.
- Install the inverter as directed in the inverter's installation guide.

## Replacing Mounting Brackets from an Up and Running Inverter Installation

When replacing the brackets you should refer to the **Replacing and Adding System Components** section in the Installation Guide prepared for your inverter model. The following is a general guide to the operations performed when replacing mounting brackets on an up and running inverter.

### → To replace the mounting brackets

1. Turn OFF the inverter ON/OFF/P switch, and wait for 5 minutes to allow the inverter's capacitors to discharge and reach a safe DC voltage (<50V) before continuing to the next step.
2. Disconnect the AC to the inverter by turning OFF the circuit breakers on the distribution panel.
3. Continue to disconnect the inverter as instructed in the **Replacing and Adding System Components** section in the Installation Guide prepared for your inverter model.
4. Remove the screws securing the inverter to the mounting bracket and remove the inverter from the mounting bracket.
5. Remove the screws securing the mounting bracket and remove the mounting bracket.
6. Position the Corrosion Protected mounting bracket taken from the bracket replacement kit and screw the bracket to the mounting surface. Verify that the bracket is firmly attached to the mounting surface.
7. Place the new inverter on the mounting bracket and secure it using the screws.
8. Reconnect the inverter as instructed in the **Replacing and Adding System Components** section in the Installation Guide prepared for your inverter model.

## Support Contact Information

If you have technical problems concerning SolarEdge products, please contact us:

<https://www.solaredge.com/service/support>

<https://www.solaredge.com/us/service/support>

Before contact, make sure to have the following information at hand:

- Model and serial number of the product in question.
- The error indicated on the productSetApp mobile application LCD screen or on the monitoring platform or by the LEDs, if there is such an indication.
- System configuration information, including the type and number of modules connected and the number and length of strings.
- The communication method to the SolarEdge server, if the site is connected.
- The product's software version as it appears in the ID status screen.